

42U 1280 mm system cabinet relocation kit instructions

To reduce the risk of personal injury or equipment and data damage, only move the system cabinet when it is fully installed in the relocation packing crate, which includes a relocating ramp that you must unpack and attach.

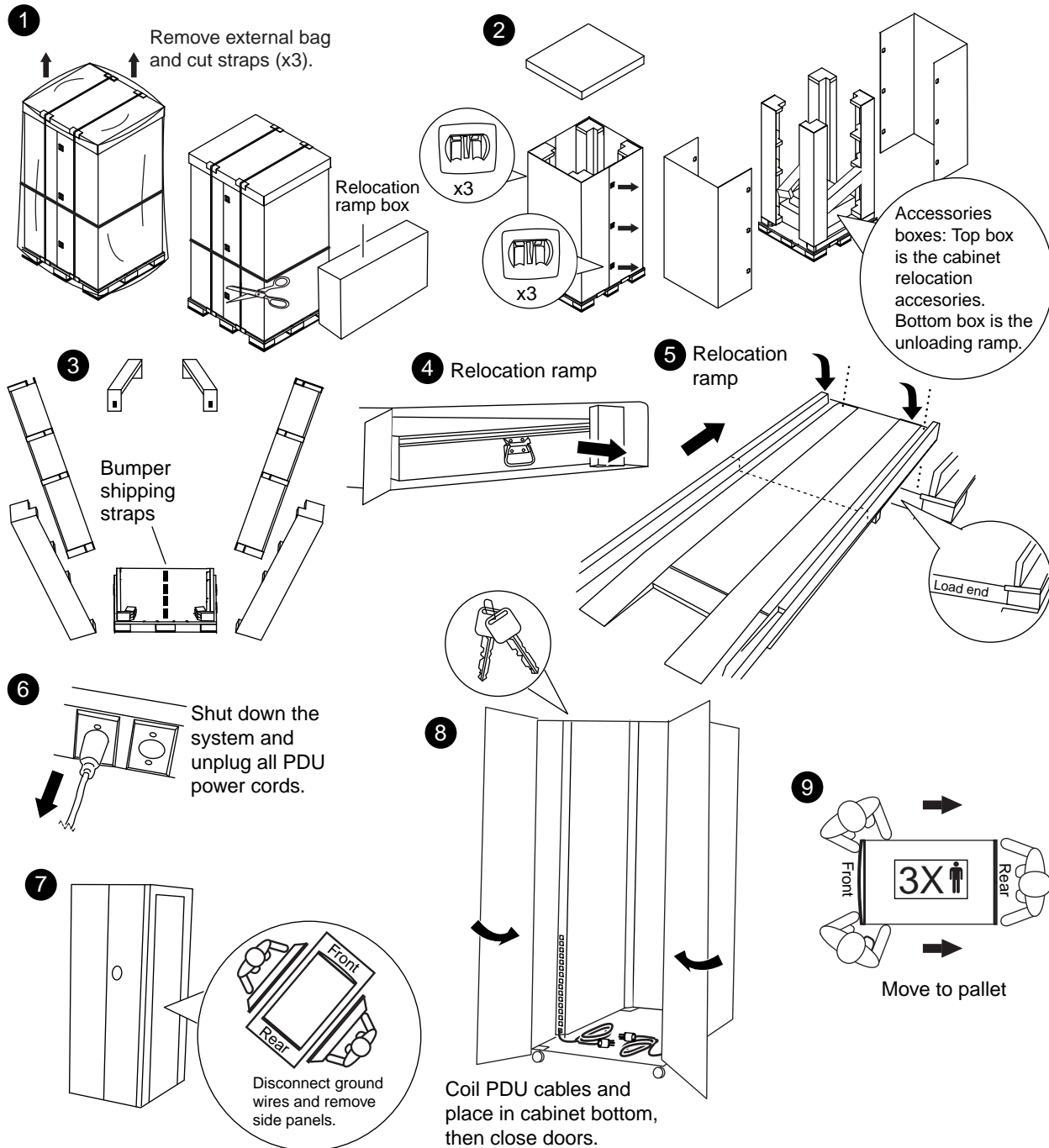

Procedure continues on next page...

10

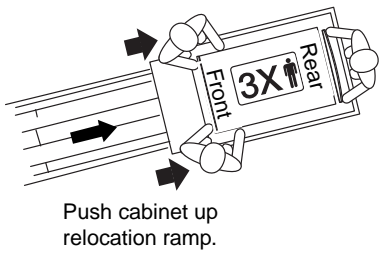

11

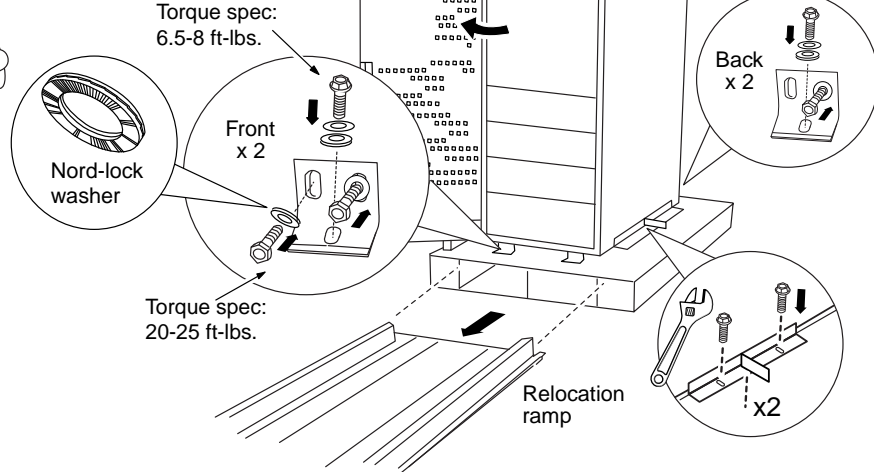

12

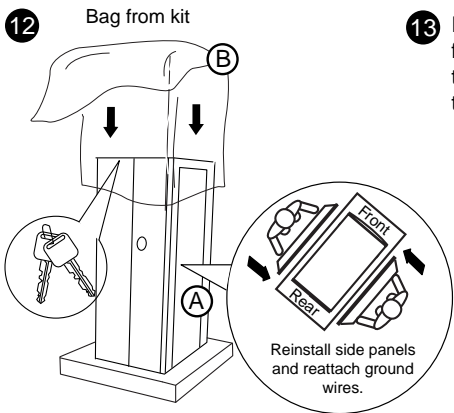

13

Install the top outside bumpers, feed strap through D-ring and into the ratchet head, and then ratchet the strap tight.

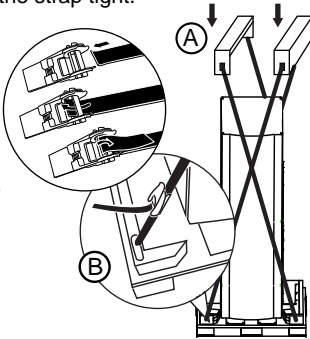

14

Strap accessory boxes and unloading ramp to cabinet before seating side bumpers.

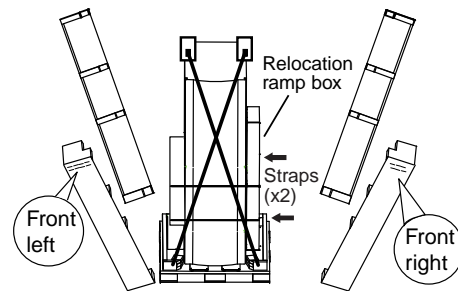

15

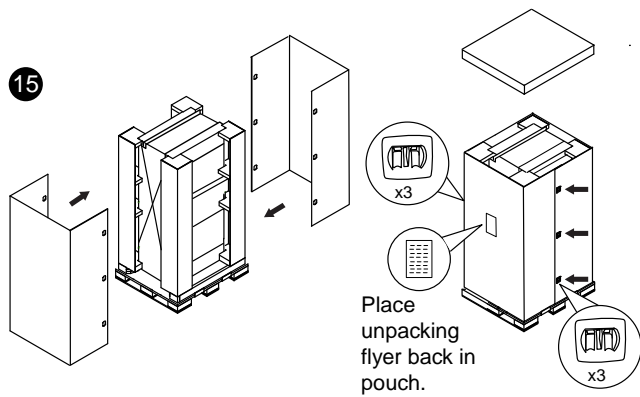

16

